

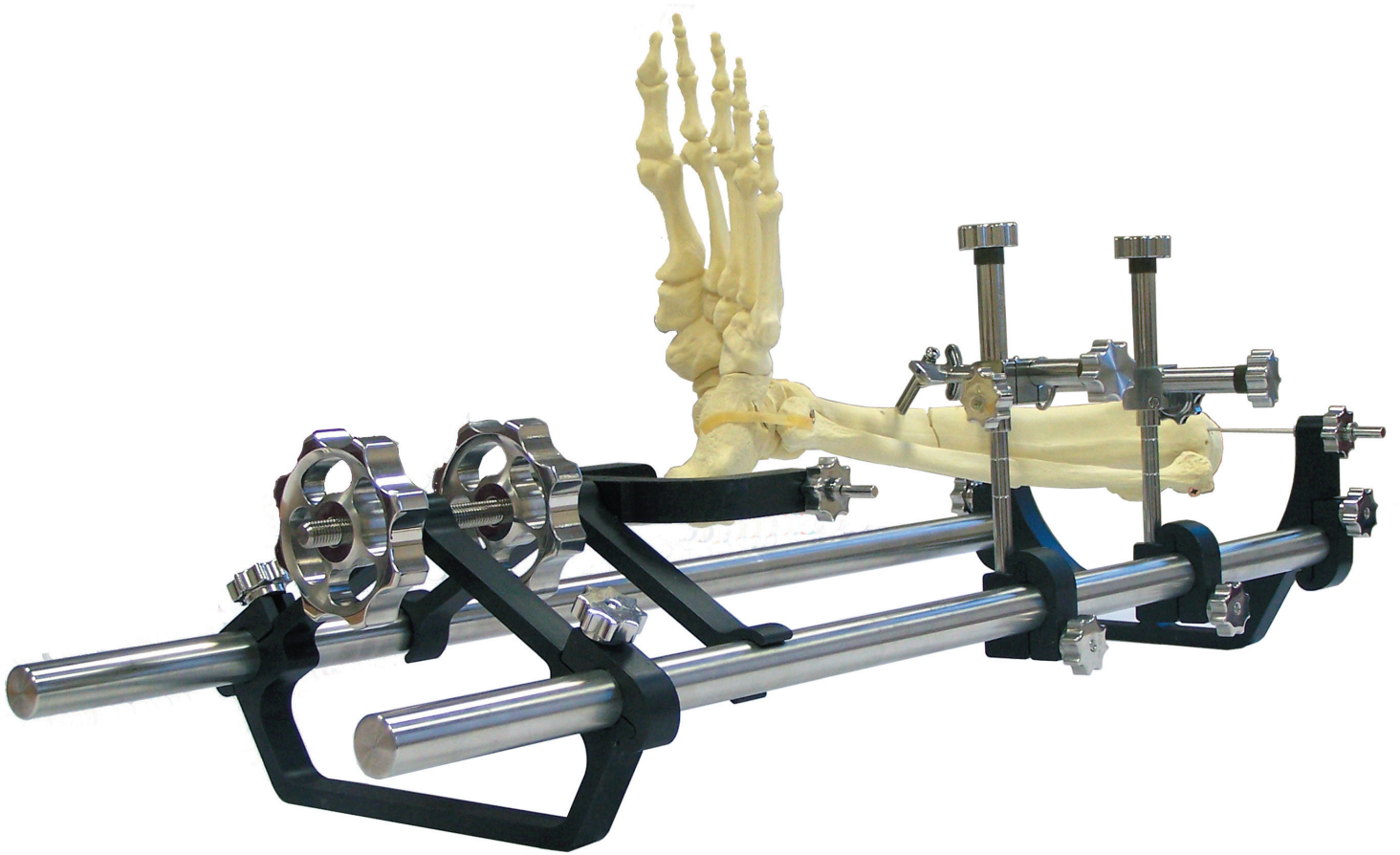

intelligent orthopaedics



## Quick Assembly Guides

## Quick assembly instructions

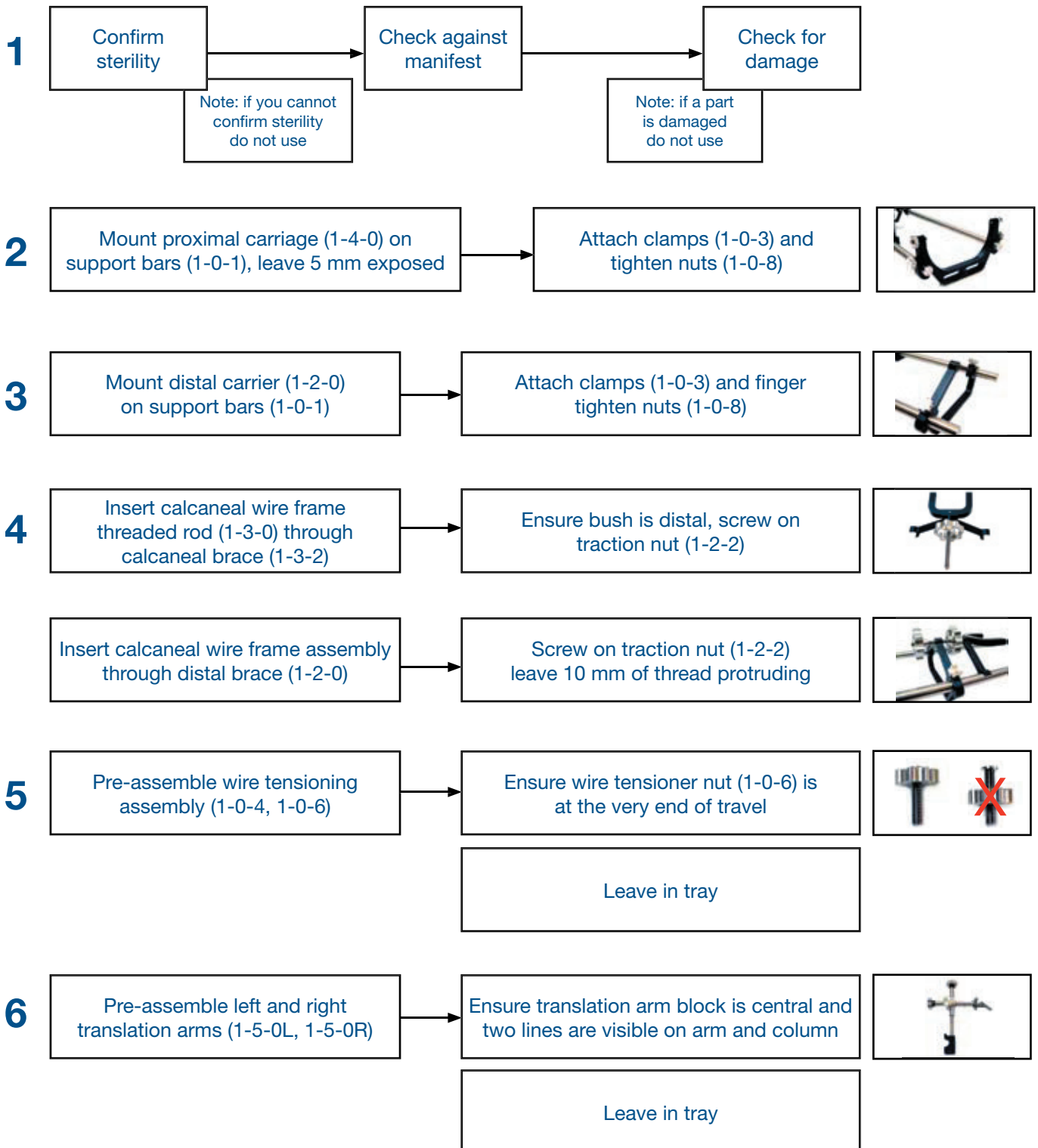

## Quick disassembly instructions

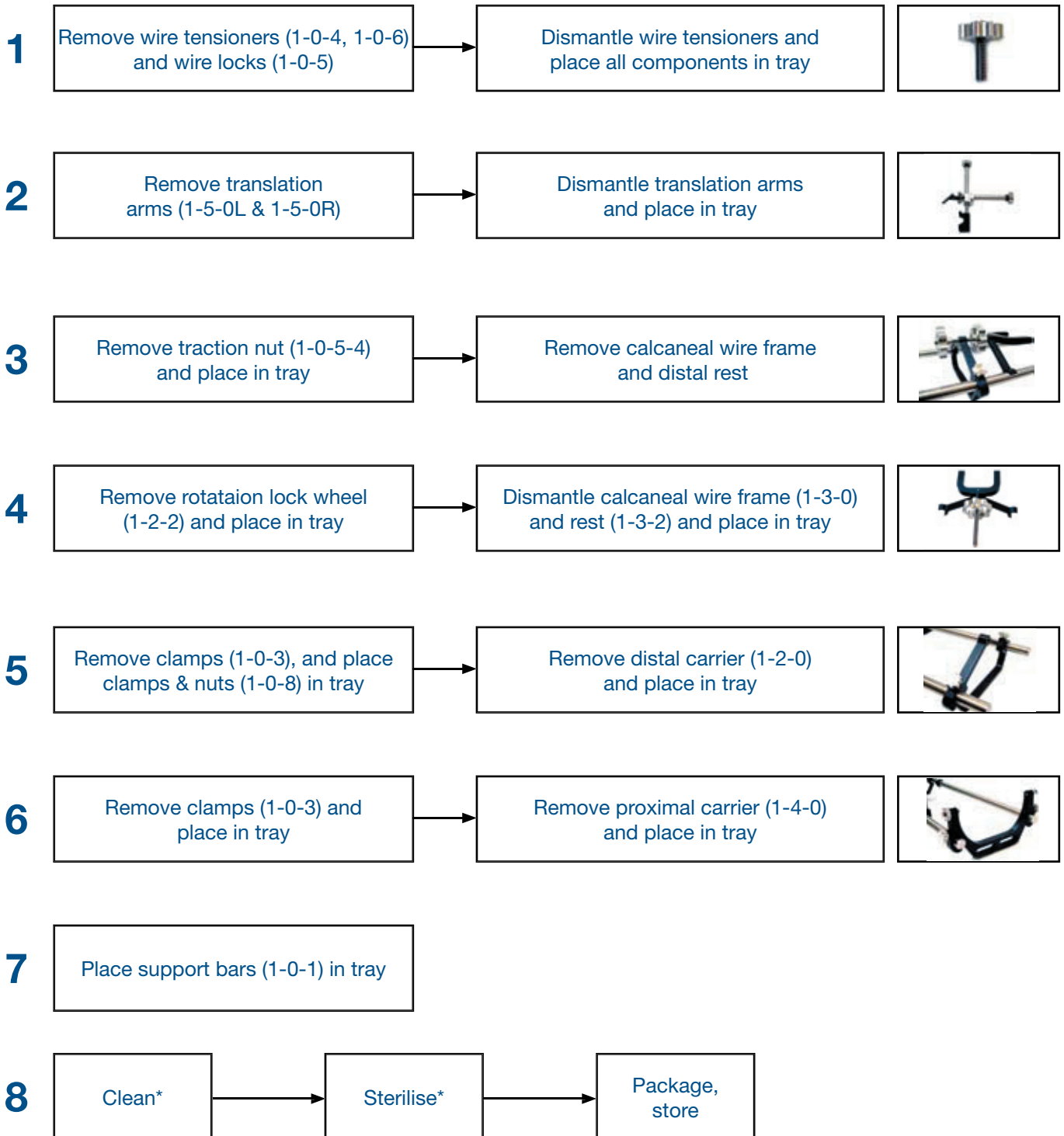

\* See cleaning and sterilisation instructions

## Quick assembly instructions (translation arms)

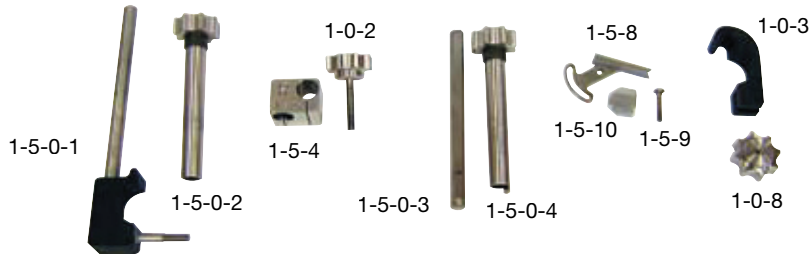

**1**

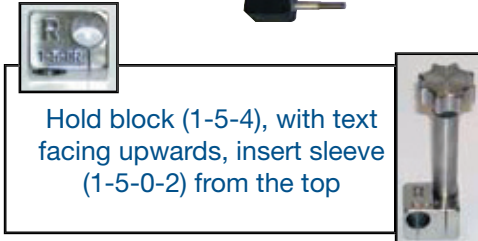

Hold block (1-5-4), with text facing upwards, insert sleeve (1-5-0-2) from the top

Screw column (1-5-0-1) into (1-5-0-2) up to middle line

Note: You will need to push slightly to engage



**2**

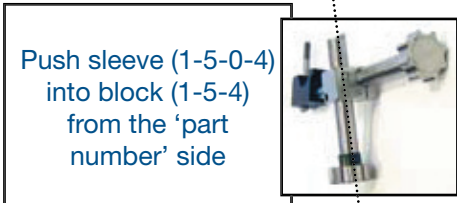

Push sleeve (1-5-0-4) into block (1-5-4) from the 'part number' side

Screw arm (1-5-0-3) into (1-5-0-4) up to middle line

Note: You will need to push slightly to engage

Insert screw (1-0-2) from opposite side of text, do not tighten



**3**

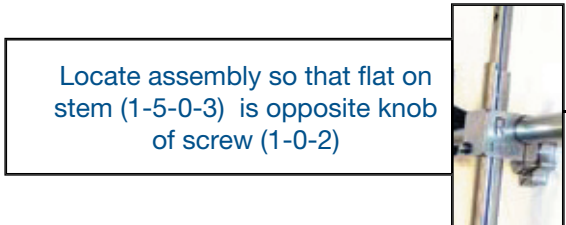

Locate assembly so that flat on stem (1-5-0-3) is opposite knob of screw (1-0-2)

Ensure that block (1-5-4) is central and tighten screw (1-0-2)

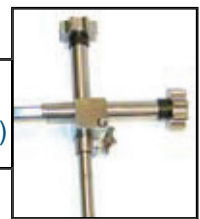

**4**

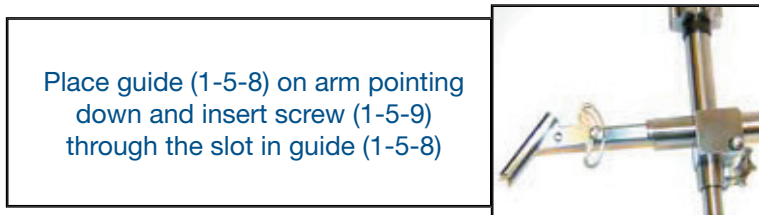

Place guide (1-5-8) on arm pointing down and insert screw (1-5-9) through the slot in guide (1-5-8)

Screw nut (1-5-10) onto screw (1-5-9), tighten lightly with guide at 45 degrees

**5**



Leave nut (1-0-8) and clamp (1-0-3) in tray

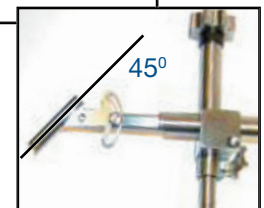

For more information contact

Intelligent Orthopaedics Ltd  
PO Box 2281  
Stoke on Trent  
UK ST4 9BE

E: [www.io-uk.com](http://www.io-uk.com)  
T: +44 (0) 844 800 4405